

# Chapel Arches

Maidenhead, Berkshire



© TP Architects

**MAX FRANK supplied Shearail® punching shear reinforcement & Egccobox® thermal breaks to this mixed-use development.**

This 3-phase development comprises "The Picturehouse", "Chapel Wharf" & "Waterside Quarter".

The scheme is part of a large-scale redevelopment project & delivers apartments, homes, restaurants & amenities, plus the Waterways Restoration Project - which brings the Thames into town.

The project as a whole provides 182 stylish apartments, 259 new homes & 30,000 sq ft of commercial space.

MAX FRANK Shearail® punching shear reinforcement & Egccobox® thermal break connectors to REI 120 were installed on this project.

## Type of building:

## Clients and Developers:

Shanly Homes

## Architect:

TP Architects

## Engineers/ Specialist Planners:

Structa LLP

## Building contractor:

Modebest Builders Ltd.

## Completion:

2021

# Chapel Arches

Maidenhead, Berkshire



## Products used:

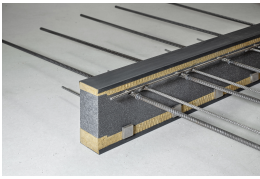

Thermal break balcony  
connector Egcoflex®



Punching shear reinforcement  
Shearail®



Chapel Arches, Maidenhead  
© TP Architects



Chapel Arches, Maidenhead  
© Shanly Homes



Chapel Arches  
© [www.maxfrank.com](http://www.maxfrank.com)