

Duka Headquarter

Brixen



duka Firmenzentrale, Brixen
© www.maxfrank.com

At duka, the South Tyrolean specialist for customised shower enclosures, all signs point to growth. In order to set the course for the future, duka AG has realised a new company headquarters next to the motorway exit Brixen south.

With this, duka continues its continuous and sustainable course of success and at the same time prepares its entry into the Industry 4.0 era with digital networking of supplier and customer cycles. Internally, the largest project in the company's history is called "duka 4.0".

In just two years, a volume of 300,000 cubic metres was installed. 18 metres high, almost 100 metres wide and 200 metres long. Production, administration, a training centre and exhibition space for customers were united in one building. The new company headquarters provides 300 jobs. More than 1,000 shower cubicles leave the premises every day.

The planning team, consisting of KUP Architekten, Grie-Plan GmbH and Holzner & Bertagnolli Engineering GmbH, hb engineering, is responsible for the structural design and geotechnics.

MAX FRANK Italy S.r.l. supplied spacers, manufactured from various materials, to maintain the concrete cover on this project. Egcodorn® shear force dowel, Stabox® reinforcement connection and Shearail® punching shear reinforcement were also used in the area of reinforcement technology.

Type of building:

Clients and Developers:

duka AG, Brixen www.duka.it

Architect:

KUP ARCH, Brixen www.kup-arch.it

Engineers/ Specialist Planners:

Grie Plan & HB - Holzner Bertagnolli engineering www.h-b.it

Building contractor:

Plattner AG, Bozen www.plattner.bz

Distributor:

TopHaus www.tophaus.com

Duka Headquarter

Brixen

Products used:



Fibre concrete bar spacers

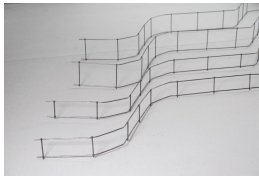

Steel chairs

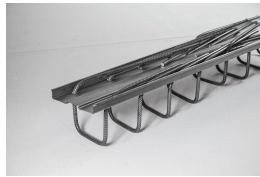

Continuity strip Stabox®

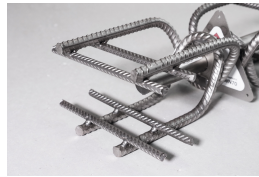

Shear force dowel Egcodorn®



Punching shear reinforcement
Shearail®



duka Headquarter
© www.maxfrank.com