

Sky Tower Breslau

Wroclaw



© <https://fotek.eu/>

Type of building:
Skyscraper

Completion:
2012

Project link:
<http://apartamentyskytower.pl/en/>

The Sky Tower is a three-part high-rise building in Poland. MAX FRANK supplied Stremaform® formwork elements for the production of the working joints.

The European Championship 2012 will trigger a building boom in Poland's event cities. The skyline of Silesian Wrocław, near Breslau, is also expanding and is set to gain a major attraction with the Sky Tower. Construction began in March 2008 and is expected to be completed in 2012.

The Sky Tower will occupy an area of 177,000 square meters. In total, the tower will have 50 floors with 236 apartments and reach a height of 212 meters.

MAX FRANK supplied Stremaform® formwork elements for the production of the working joints in the reinforced concrete construction and the Egcodorn shear force dowels. The heavy-duty, corrosion-resistant Egcodorn transmits maximum forces with minimal component thicknesses. Fibre-reinforced concrete spacers were also used in the project to guarantee the compliance of the concrete cover before and during concreting.

Sky Tower Breslau

Wroclaw

Products used:

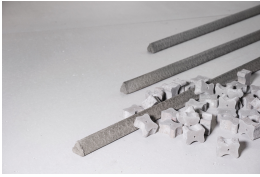

Fibre concrete spacers



Stay-in-place formwork for working joints Stremaform®

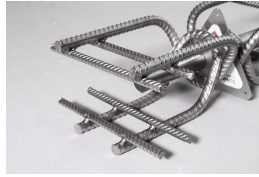

Shear force dowel Egcodorn®



© <https://fotek.eu/>



© <https://fotek.eu/>

Sky Tower Breslau

Wroclaw



© <https://fotek.eu/>