

Kingston Gas Works

Kingston Upon Thames, Surrey



© <https://cjctstudios.com>

In October 2015 Berkeley Homes obtained planning permission to redevelop the former Kingston Gas Works site.

The scheme is a 9 storey building comprising of 47 one bedroom, 64 two bedroom and 2 three bedroom flats with an associated gymnasium, parking and landscaping works. Some of the residential developments will be shared ownership for key workers who live or work within the borough. The development will include a new vehicular access off Seven Kings Way to serve the residents' basement car park, as well as new public realm and landscaping.

As part of the approach over £2.2 million will be invested in the local community and this has been spent on items including education and healthcare in the borough, a new linear park, improved pedestrian and cycle paths, a new Village Hall and a new culinary training restaurant in conjunction with Kingston College.

[Pecavoid®](#) is an approved cellular void former designed to combat the effects of clay heave on foundations. Pecavoid® is used to reduce the uplift pressure caused by clay heave on concrete slabs, rafts and piled foundations. A variety of different grades was used within the project allowing further savings for the contractors.

Type d'ouvrage:

Entreprise de construction:

Henry Construction

<http://henryconstruction.co.uk/>

Achèvement:

2018

Lien projet:

<https://cjctstudios.com/work/residential/kingston-gas-works/>

Kingston Gas Works

Kingston Upon Thames, Surrey



Produits utilisés:



Coffrage pour sols argileux
Pecavoid®



© www.maxfrank.com



© <https://cjctstudios.com>



© www.maxfrank.com

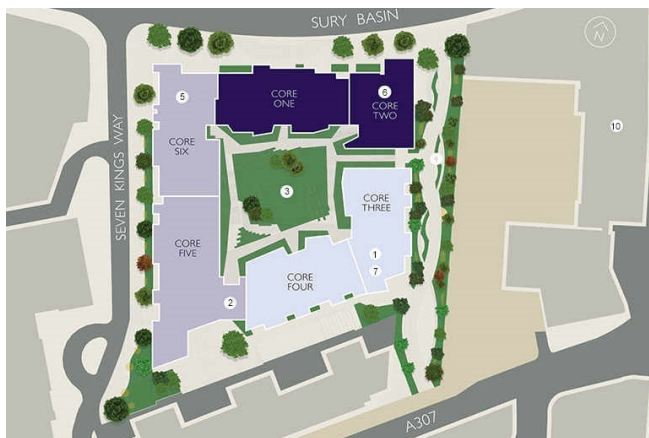

© <https://cjctstudios.com>