

Alte Baumwolle Flöha

Flöha, Germany



© www.maxfrank.com

Type of building:
Education facility

Building contractor:
Hoch- und Tiefbau HTB GmbH,
Rochlitz
www.htb-rochlitz.de

Distributor:
Teuchert Handels GmbH & Co.KG
www.tbi-gmbh.de

Completion:
2013

A daycare centre for 370 children has been built on the factory site of the "Alte Baumwolle" in Flöha. Saxony's largest daycare centre opened at the end of 2013.

As part of the federal-state program "Active urban and district centres" the historic shed space of the city Flöha was converted into a day care centre. The Free State of Saxony funded this conversion and thus created 168 crèche, 130 kindergarten and 60 after-school places. The old buildings are being turned into two-storey new builds which contain group rooms and multipurpose rooms. The previous building floorplan with its seven skylights has been preserved and transformed into a light-flooded building complex. The opening of Saxony's largest daycare centre is scheduled for December 2013.

Complicated formwork work in the area of dilatation joints was avoided by using the Egcodorn shear force dowels. The unique corrosion-protection system and the use of high quality materials guarantee maximum safety. The used shear force dowels allow the absorption of longitudinal and transverse movements. The combination of simple installation and minimal costs were the deciding factor in awarding the contract for the MAX FRANK shear force connection. The Egcoibox® cantilever connector was used to structurally connect the balconies to the building and, with the integrated insulation, the building meets the requirements of the KfW Efficiency House 70 Standard.

Alte Baumwolle Flöha

Flöha, Germany



Products used:

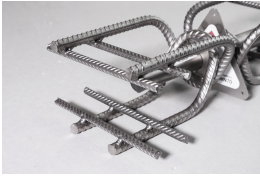

Shear force dowel Egcodorn®

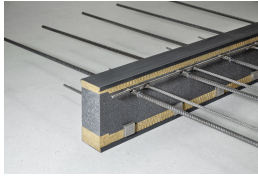

Thermal break balcony connector Egobox®



© www.maxfrank.com



© www.maxfrank.com



© www.maxfrank.com



© www.maxfrank.com